

# CFW SPOOLING

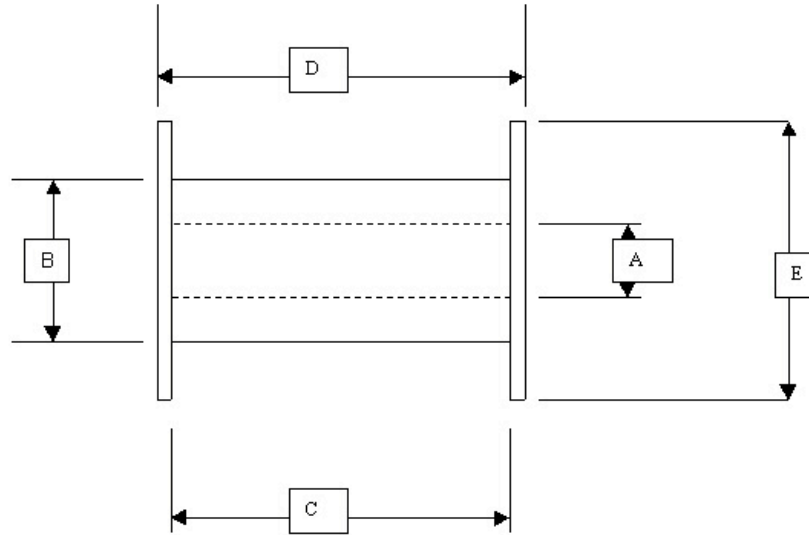

A= bore size of spool  
 B= barrel diameter of spool minus flange  
 C= barrel length from flange to flange  
 D= length of spool flange to bottom rim  
 E= flange diameter

## Spools for Bonding Wire

Part No.	Material	Dimensions					Finish
		A	B	C	D	E	
<a href="#"><u>TS-1</u></a>	Aluminum	0.503	0.530	0.720	0.75	0.685	Anodized
<a href="#"><u>AI-3</u></a>	Aluminum	1.905	1.98	0.995	1.11	2.250	Anodized
<a href="#"><u>AL-8</u></a>	Aluminum	1.933	1.98	0.995	1.11	2.250	Anodized
<a href="#"><u>AL-9SE</u></a>	Aluminum	1.933	1.98	1.093	1.15	2.250	Anodized
<a href="#"><u>AL-22</u></a>	Aluminum	1.933	1.98	1.990	2.13	2.250	Anodized

*[Underline indicates link to photo & additional spool information.]*

## Maximum Feet/Spool/Layer for various Wire Diameters

Wire Size	Spool Types											
	<u>TS-1</u>	ML		<u>AL-3 &amp; AL-8</u>	ML		<u>AL-9</u>	ML		AL-22	ML	
		AL	AU		AL	AU		AL	AU		AL	AU
0.00070	115	11	3	400	11	3	400	1	1	800	1	1
0.00080	115	11	3	400	11	3	400	1	1	800	1	1
0.00090	90	11	3	400	11	3	400	1	1	800	1	1
0.00100	90	11	3	375	11	3	325	1	1	750	1	1
0.00110	80	11	3	350	11	3	325	1	1	700	1	1
0.00120	80	11	3	325	11	3	300	1	1	650	1	1
0.00125	75	11	3	325	11	3	300	1	1	650	1	1
0.00130	75	11	3	325	11	3	275	1	1	650	1	1
0.00150	60	11	3	300	11	3	275	1	1	600	1	1
0.00200	45	11	3	175	11	3	175	1	1	350	1	1
0.00300	30	11	3	125	11	3	125	1	1	250	1	1
0.00400	22	11	3	100	11	3	100	1	1	200	1	1
0.00500	17	11	3	60	11	3	60	1	1	120	1	1

It is recommended spooling be in odd numbered layers.

Note: ML=Maximum layers per spool

AL=Aluminum

AU=Gold

*[Underline indicates link to photo & additional spool information.]*